



Connection with Stranded Cable



Description

- Flexible wire :
- Push-mounted from rear-side
- 1 Function Connection with stranded Cable
- Quick connect terminals 4.8 x 0.8 mm
- Approved together with power entry module

References

Fits to type: CE; CG; CG-Bowdencable; KE; KG; KG-Bowdencable

Weblinks

[pdf datasheet](#), [html-datasheet](#), [General Product Information](#), [RoHS](#), [CHINA-RoHS](#), [REACH](#), [Distributor-Stock-Check](#), [Accessories](#), [Detailed request for product](#)

Dimension

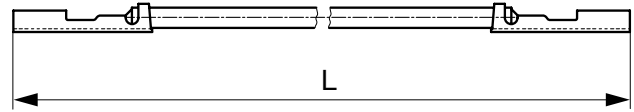
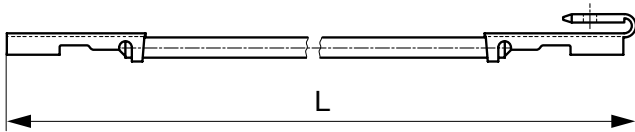

Type A, (Lenght see order table)

Type B (Length see order table)

All Variants

Type	L [mm]	System 1 Anzahl	System 2 Anzahl	System 3 Anzahl	System 4 Anzahl	Order Number
Type A	70 mm	1	1	1	-	0881.0074
Type A	100 mm	1	1	1	-	0881.0075
Type B	70 mm	1	-	-	1	0881.0076
Type B	100 mm	-	-	-	1	0881.0077

Most Popular.

Availability for all products can be searched real-time: <http://www.schurter.com/en/Stock-Check/Stock-Check-SCHURTER>

For 2-pole versions 2 x 0881.0074 is needed in system no. 2 and 3 resp. 2 x 0881.0076 in system no. 4

Packaging unit 100 Pcs