

1

2

3

4

5

6

7

Male

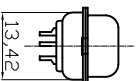
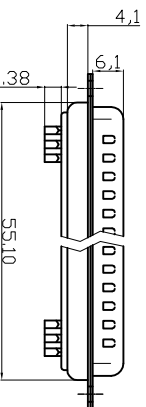
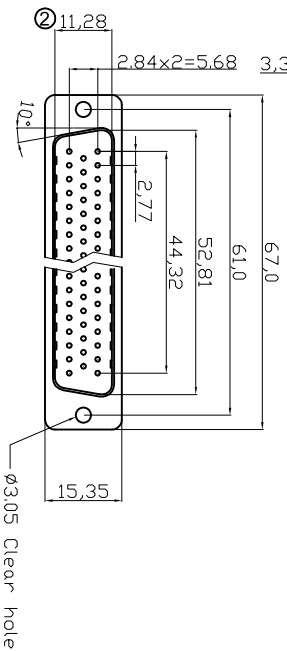
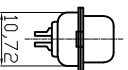
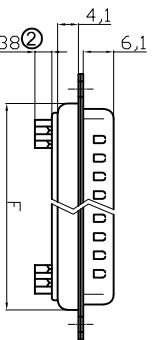
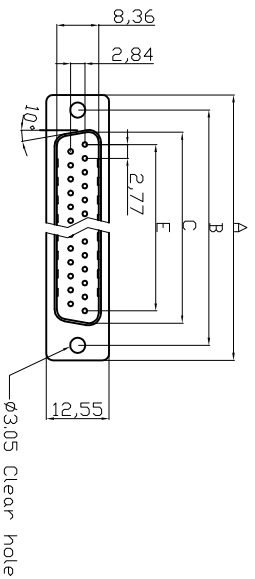

50 Positions

Dimensions	A	B	C	E	F
Positions	30.81	24.99	16.92	11.08	19.20
9	39.20	33.30	25.25	19.39	27.70
25	53.04	47.04	38.96	33.24	41.10
37	69.40	63.50	55.42	49.86	57.30

**Electrical**  
 Contact Resistance : 20 milliohms Max at 1 AMP DC.  
 Insulation Resistance : 1000 megohms at 500 VDC  
 Dielectric Withstanding Voltage : 1000 VAC/rms 60Hz for 1 minute  
 Current Rating : 3 AMP  
 Voltage Rating : 250 VAC/rms 60Hz  
 ① OPERATING TEMPERATURE:-55°C+105°C  
 Order Code:

A-Dx xx LLZ  
 Contact style: LLZ - Selective gold\*  
 F - Female  
 S - Male  
 No. of Contacts 09 / 19 / 29 / 37  
 \* Quality class III

**RoHS compliant**  
 Unit: mm  
  
 File No.: E198287

Scale	Free	
TOLERANCE		
X.	±0.38	② Cancel "Cinch Nut" & "Screwlock"
X.X	±0.25	③ Add the UL number
X.XX	±0.13	② Update the dimension
DIM	TOL	① Update operation temperature range
X.°	±3°	① Drawn
X.X°	±1.0°	
Angle	TOL	Id.

Date	Name	Customer-No.
17.06.2016	Winnie	
03.04.2015	Winnie	
27.02.2015	Winnie	
13.05.2014	Winnie	
15.08.2012	Lucas	

ASSMANN	Customer-No.	Drawing-No.
WSW/ components	ASSMANN WSW-No.	A-Dx xx LLZ
		ASS 4884 CO

1

2

3

4

5

6

7

H

G

F

E

D

C

B

A

Sheet 1/2

rev04

Replace

1

2

3

4

5

6

7

Female

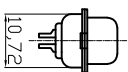
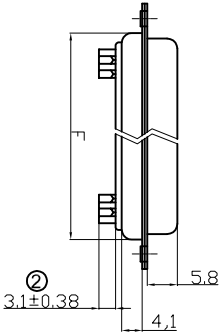
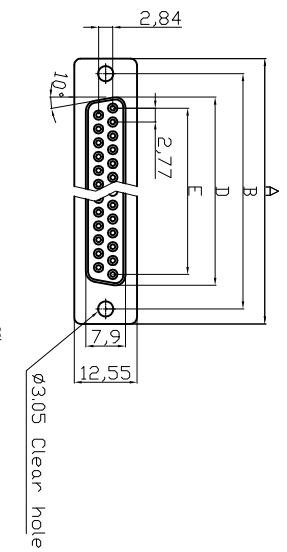

Electrical

- Contact Resistance : 20 milliohms Max at 1 AMP DC.
- Insulation Resistance : 1000 mohms at 500 VDC
- Dielectric Withstanding Voltage :1000 VAC/rms 60Hz for 1 minute
- Current Rating : 3 AMP
- Voltage Rating : 250 VAC/rms 60Hz
- ① Operating Temperature : -55°C+105°C

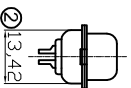
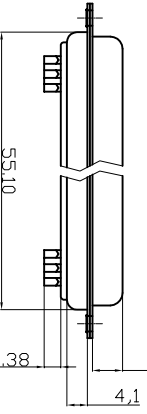
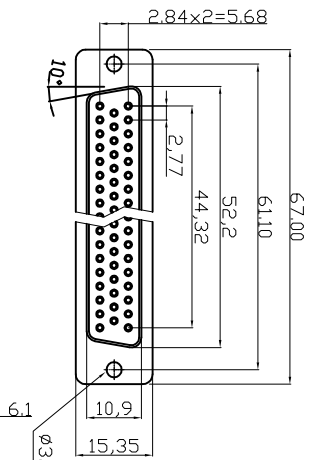

Dimensions Positions	A	B	D	E	F
9	30.81	24.99	16.33	11.08	19.20
15	39.20	33.30	24.70	19.39	27.70
25	53.05	47.04	38.40	33.24	41.10
37	69.40	63.50	54.84	49.86	57.30

50 Positions

② 3.1±0.38

RoHS compliant

Unit:mm



File No.: E198287

Scale	Free				
TOLERANCE					
X.	±0.38	④ Cancel "Cinch Nut "&"Screwlock"	17.06.2016	Winnie	Drawn
X.X	±0.25	③ Add the UL number	03.04.2015	Winnie	Approved
X.XX	±0.13	② Update the dimension	27.02.2015	Winnie	
DIM	TOL	① Update operation temperature range	13.05.2014	Winnie	
X.°	±3°	① Drawn	15.08.2012	Lucas	
X.X°	±1.0°				
Angle	TOL	Id.	Modification	Date	Name

Customer-No.

ASSMANN WSW-No.

A-Dx XX LL/Z

Drawing-No.

ASS 4884 CO

rev04



Replace

Sheet 2/2

1

2

3

4

5

6

7

H

G

F

E

D

C

B

A

H

G

F

E

D

C

B

A