

THIS DOCUMENT IS SUBJECT TO CHANGE WITHOUT NOTICE. IT IS CONFIDENTIAL AND A PROPERTY OF AMPHENOL LTW. DISCLOSURE TO THIRD PARTY HAS TO BE AUTHORIZED BY AMPHENOL LTW.

REV.	ECN NO.	DATE	SIGN	DESCRIPTION

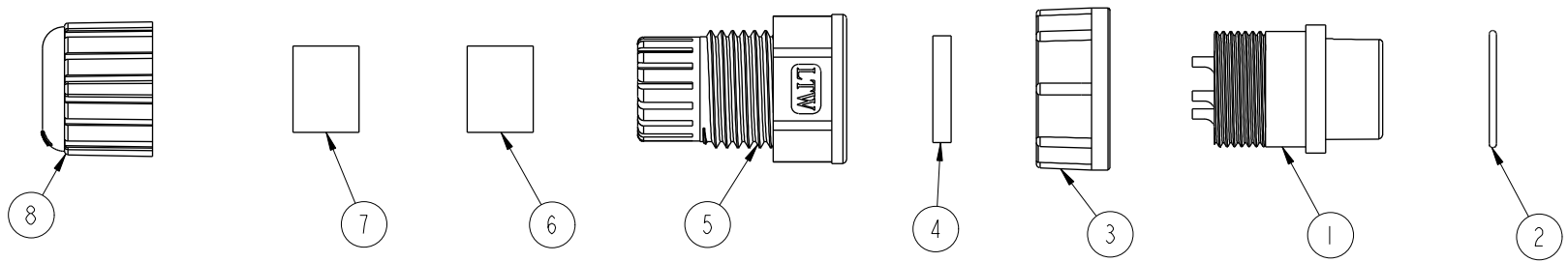

**ALTW**  
**CONFIDENTIAL**  
 2012-04-05  
**R&D DEPT.**

**ALTW**  
**DCC. DEPT.**  
**CONFIDENTIAL**  
 2012-04-25  
**ISSUED**

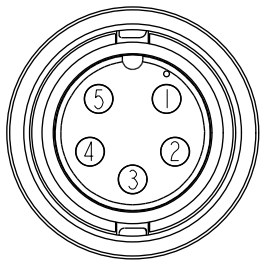

Pin Assignments  
Front View

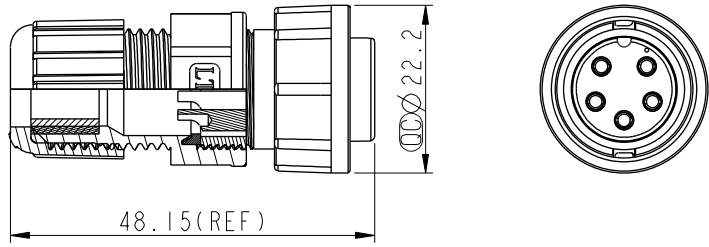

- Note:
- \*  $\varnothing$  Important Dimension To Check.
  - \* Waterproof Rate: IP67
  - \* Housing: Nylon+GF, Black.
  - \* Female Pin: Copper Alloy, Gold Plated.
  - \* O-Ring: EPDM, Black.
  - \* Lock Nut: Nylon+GF, Black.
  - \* Gasket: EPDM, Black.
  - \* Clamp Ring: Nylon, Black.
  - \* Sealing Nut: Nylon, Black.
  - \* Seals B1 for Cable OD:  $\varnothing 7.6\text{mm} \sim \varnothing 9.6\text{MM}$
  - \* Seals B2 for Cable OD:  $\varnothing 4.0\text{MM} \sim \varnothing 7.6\text{MM}$
  - \* One Set Unassembled in One PE Bag.

UNIT:mm   TOLERANCE .X $\pm 0.25$ .XX $\pm 0.1$ .XXX $\pm 0.05$ ANGLES $\pm 1^\circ$	TITLE Middle, Assy Lock 5Pin F Conn F Pin			<h1 style="text-align: center;">Amphenol LTW</h1> <p style="text-align: center;">安費諾亮泰企業股份有限公司</p>		ITEM NO CB-05BFFA-LL7001	DRAWN BY SamChang	DATE 2012-04-05
	SCALE 1:1	SIZE A4	SHEET 1 OF 1			DWG NO CB-05BFFA-LL7001	CHECKED BY Jeffrey	DATE 2012-04-25
	REV. A	WC-REV. A.2	: Inspection item			CUSTOMER ALTW	APPROVED BY Lion	DATE 2012-04-25